

ALPS

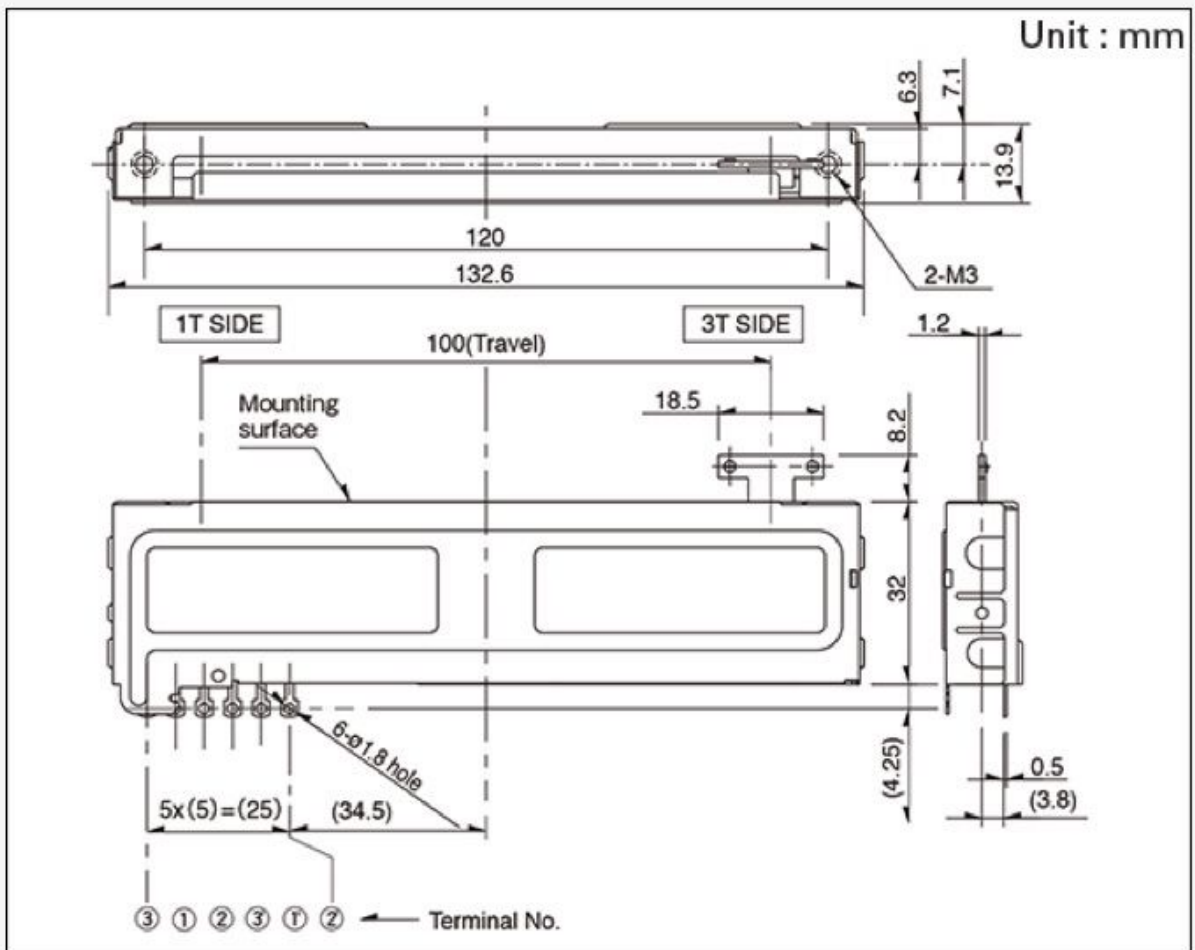

Dimensions



Lever Dimensions

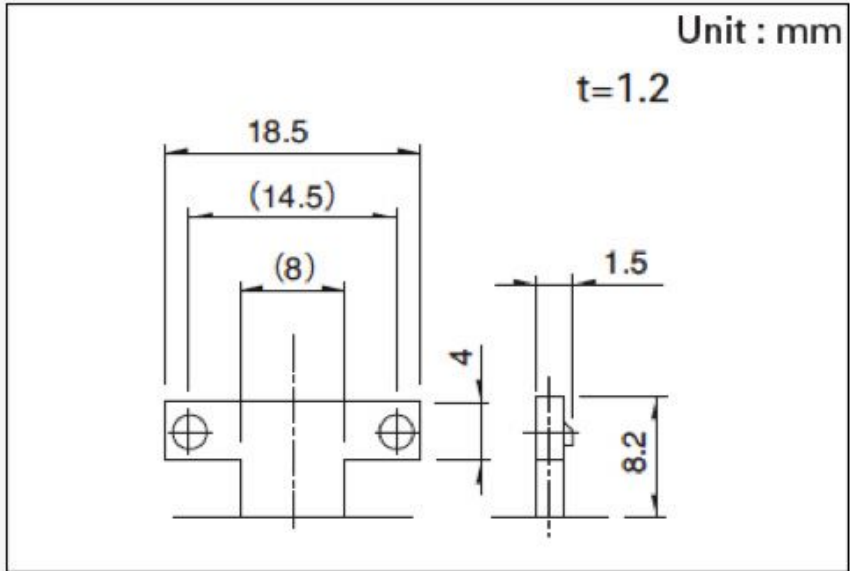

Circuit Diagram

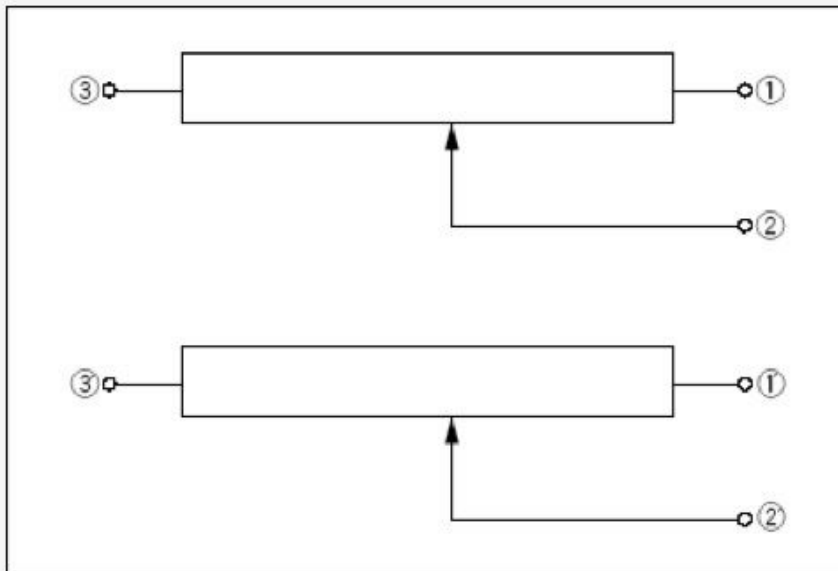

Basic information

Number of resistor elements	Dual-unit
Direction of lever	Vertical
Travel	100mm
Type	Standard type
Lever type	9-T (T-Bar)
Length of lever	8.2mm
Total resistance	10k Ω
Resistance taper	15A

Specifications

Operating temperature range	-10°C to +60°C	
Durability	Operating life	100,000 cycles
Electrical performance	Total resistance tolerance	$\pm 20\%$
	Maximum operating voltage	350V AC, 20V DC
	Rated power	0.25W
	Insulation resistance	100M Ω min. 250V DC
	Voltage proof	250V AC for 1 minute
Mechanical performance	Operating force	0.4 \pm 0.3N
	Stopper strength	100N
	Lever push-pull strength	100N
	Lever wobble (Both side)	1.312mm
	Lever deviation (One side)	0.5mm max.

Packing Specifications

Bulk

Number of packages (pcs.)

1 case / export packing 100

Export package measurements (mm)

524×374×201

Soldering Conditions

Reference for Hand Soldering

Tip temperature

350°C max.

Soldering time

3s max.



AUDIO ENGINEERING
www.audio-engineering.eu



AUDIO DISTRIBUTION
www.audio-distribution.eu